



**INDUSTRIAL**  
The First **Dry** Electropolishing System

# ***DLyte100I+Ti***<sup>®</sup>



***DLyte100I+Ti***<sup>®</sup> new patented machine for grinding and polishing Steel and Stainless-steel, Cobalt Chrome, Titanium, Nickel and Precious Metals.

Machine patented and manufactured by **GPAINNOVA**



The use of Patented DryLyte Technology is a concession approved by DryLyte Company

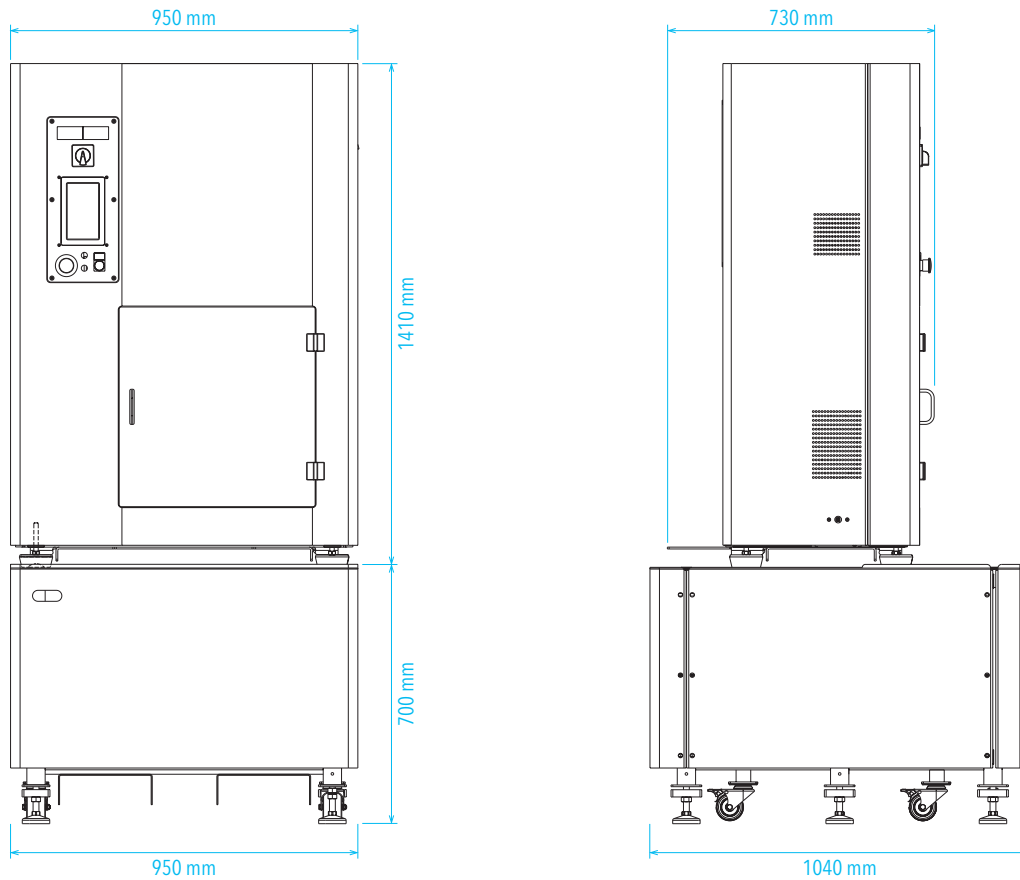

SERIES MODEL	FREQUENCY
<b>DLyte100i+Ti</b>	LF and HF

TECHNICAL SPECIFICATIONS	
CAPACITY (PER CYCLE)	180 Ø x 80 mm (maximum volume centered to the axis)
MACHINE DIMENSIONS	950 x 730 x 1410 mm
SUPPORT DIMENSIONS	950 x 1040 x 700 mm
MACHINE WEIGHT	217.5 kg (230 V)
SUPPORT WEIGHT	100 kg
POWER	5 kW ☺ (single phase with industrial plug)
VOLTAGE	220-240 V
AIR PRESSURE	4-5 bar (air connector diameter: 8mmØ or 1/4' BSP')

Consumption of 40 l/min. The air quality must be 1.5.1\* according to ISO 8573.  
 (\*) Air quality required for a maintenance every 6 months (change of filters).